

# Chic, small SPACE

This compact but efficient kitchen proves that size doesn't matter, but sound planning does

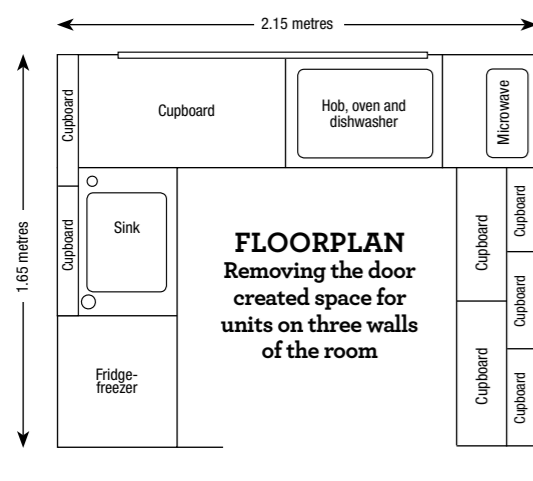

## WHO LIVES HERE...

Elena Wright, 47, a sculptor and designer, and her husband Andrew, 57, an engineer, live in this two-bedroom flat in southwest London

## WHAT IT COST

- Paint... £32.50
- Flooring and fitting... £800
- Units... £7,260
- Worktop... £2,004
- Sink and taps... £1,225.20
- Appliances... £2,195.99
- Total... £13,517.69

### In detail

\* CLEVER LAYOUT TO MAKE THE MOST OF THE SPACE

\* SHALLOW CUPBOARDS CHOSEN TO FIT THE SMALL AREA

\* HIGH-GLOSS UNITS REFLECT LIGHT AROUND THE ROOM

\* CAREFULLY SELECTED APPLIANCES SAVE ON SPACE

\* BRIGHT ACCENTS ADD PERSONALITY



A worktop-mounted unit with cutlery drawers and an alcove to hold a microwave utilises vertical space

## What was wrong with your old kitchen?

Everything! It just hadn't been thought through. It was a real bachelor pad kitchen with two runs of units that stuck out too far into the small area. There was a tiny fridge, an oversized five-burner hob with a huge extractor hood and limited storage. It was a show kitchen and just wasn't practical.

## When did you begin working on the room?

Andrew and I bought the flat in December 2010 but had to wait for permission from the building's landlord before starting any work. The kitchen was fitted the following July.

## Did you find it difficult choosing units for such a compact space?

We knew that this kitchen would be a challenge; it's the smallest one I've ever had. However, finding a company to make an inexpensive, contemporary, bespoke kitchen proved unexpectedly difficult. I followed up recommendations but even those that were able to adapt the width of units couldn't

change the depth - and shallow cupboards were crucial.

## How did you come up with the new layout?

Limited space meant there were only one or two possible layouts. By removing a door we were able to use three walls for units and appliances. It was still limiting, though, and I was originally told that I'd have to choose between an oven and a dishwasher. I said to Andrew, 'Either you start washing up or I stop cooking.' But the kitchen company sourced a combination oven/dishwasher, which solved that problem.

## You must have been pleased to find a supplier

I wasn't prepared to pay high-end prices and after extensive internet research, I came across Amberth. I liked the clean, modern lines of its units and was impressed with the quality when I visited a showroom. The company was also able to offer me a quick turnaround - from order to delivery took around three weeks.

## Any other big decisions?

We fitted a two-burner hob so we could have more work

CONTINUED OVER PAGE

**ELENA SAYS:** 'It's incomparable to the previous kitchen. The process was like a big jigsaw puzzle – every millimetre was so precious. We're amazed that all the accessories fit into the space so well, and now only think about its size when we have people over and wonder how many of us can actually fit in!'



space. I decided against using a colourful marble worktop; this room needs as little distraction as possible, so I chose practical black granite. Although it's L-shaped, the small area meant I could have a single seamless piece at no extra cost.

### Was it easy fitting the units?

As the room is so tiny, it wasn't possible to have many people working at the same time. Jobs had to be done in chronological order rather than simultaneously. Careful planning was essential and fortunately it all ran pretty smoothly. The only problem was fitting the granite worktop, which was tricky to manoeuvre, and one of the cupboard doors was damaged in the process.

### What's your favourite part of the room?

The sliding-glass cupboard doors were my idea. My Russian grandmother had something similar many years ago. Sentiment aside, it proved a great way to break up the uniformity.

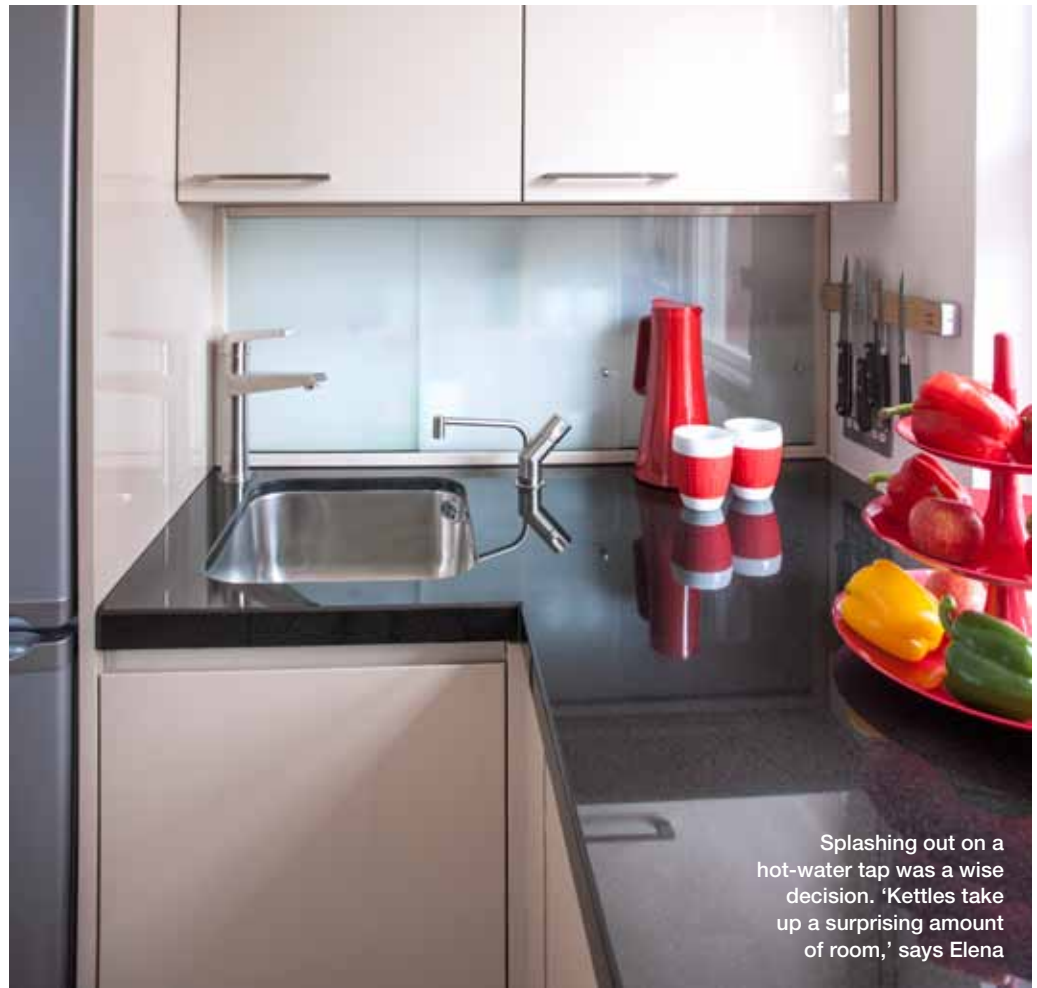

Splashing out on a hot-water tap was a wise decision. 'Kettles take up a surprising amount of room,' says Elena



The combination oven/dishwasher solved a crucial space issue



### CORNER SOLUTION

The deep-set unit offers versatile storage in a tricky spot. Pull-out shelves mean there's easy access to all its contents. The door has no handles so even when it's open, it doesn't obstruct the adjacent sink and work surface.

## GET THE LOOK

**WALLS** painted in Stone I, £32.50 for 2.5L, Paint Library. Specially treated oak **FLOORING**, £160 a sq metre, Schotten & Hansen. Beige Chinese high-gloss and white laminated glass **UNITS**, £7,260; Nero Assoluto Granite **WORKTOP**, £2,004; single-lever brushed-steel **TAP**, £214.80; Quooker brushed-steel chrome **HOT-WATER TAP**, £900; Blanco Supra single-bowl **SINK**, £110.40; Candy combination **OVEN/DISHWASHER**, £948; all Amberth. Panasonic slimline combination **MICROWAVE**, £199.99, Currys. Hotpoint FFA52 **FRIDGE-FREEZER**, £319; AEG Crystalline **INDUCTION HOB**, £729; Red **JUG**, £45; Koziol **CAKE STAND**, £19.95; red/white **CUPS**, £18 for two; Keep Calm **TEA TOWEL**, £10; all John Lewis

FOR STORE DETAILS SEE 'WHERE TO BUY' PAGE AT BACK OF ISSUE